

# GLAMP-FOOT

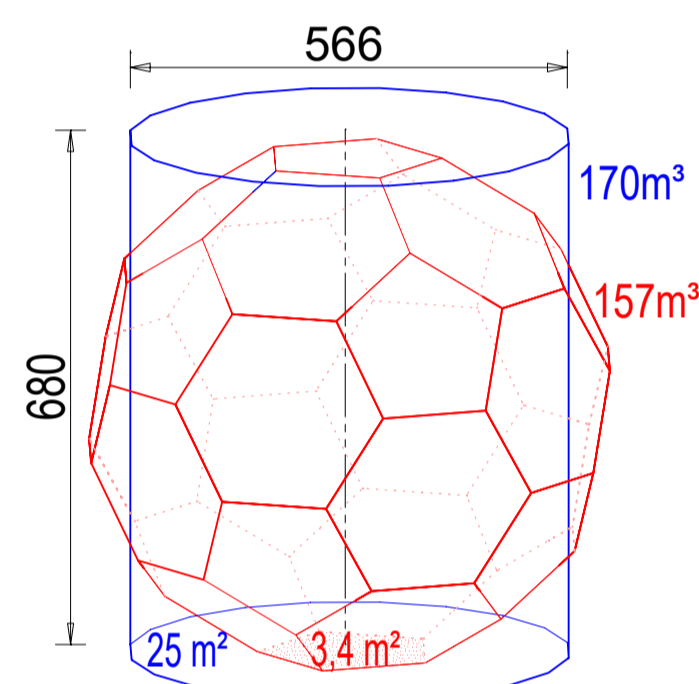

La structure, en forme d'isocàèdre tronqué se compose de 20 hexagones et 12 pentagones ayant des côtés de même dimension ce qui permet de limiter la fabrication à 2 modules de base en bois de sapin local. Le faible poids d'un module (+/-90 kgs) ne nécessite que des engins de levage légers.

## ELEMENTS STRUCTURELS

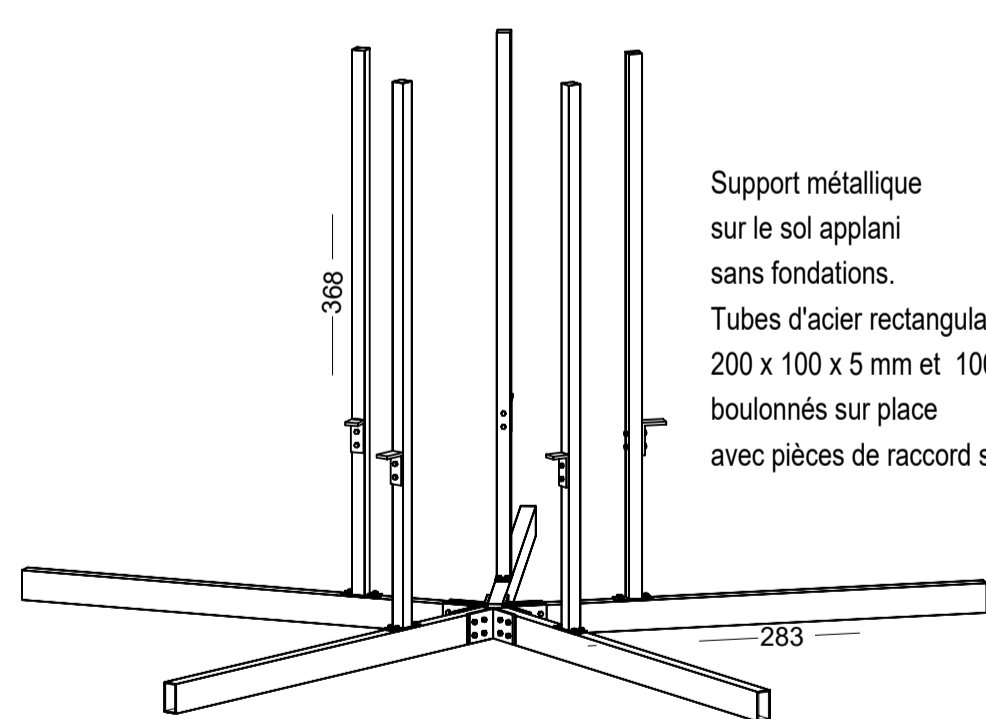
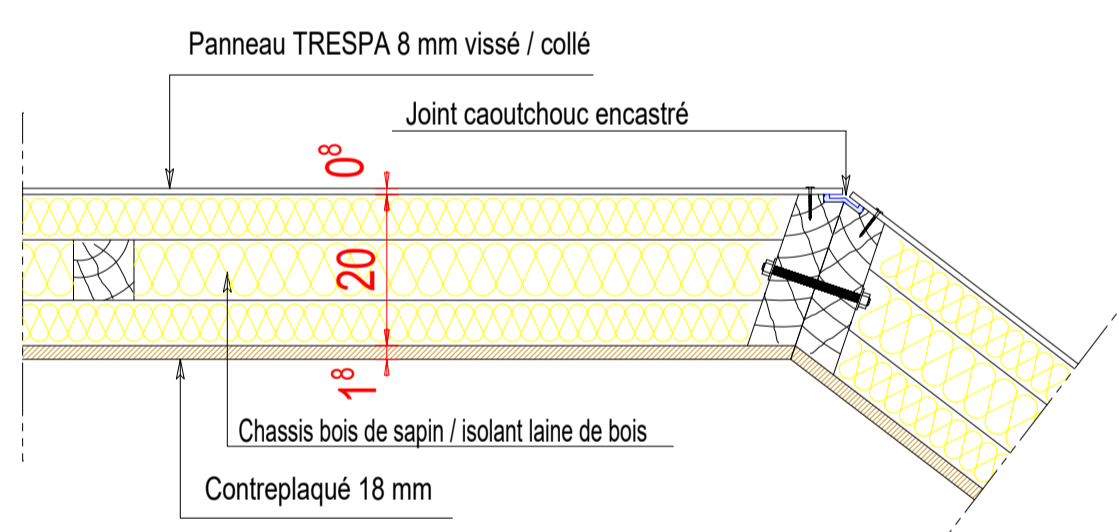
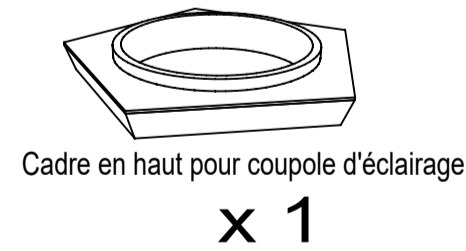
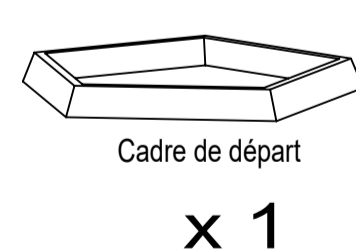
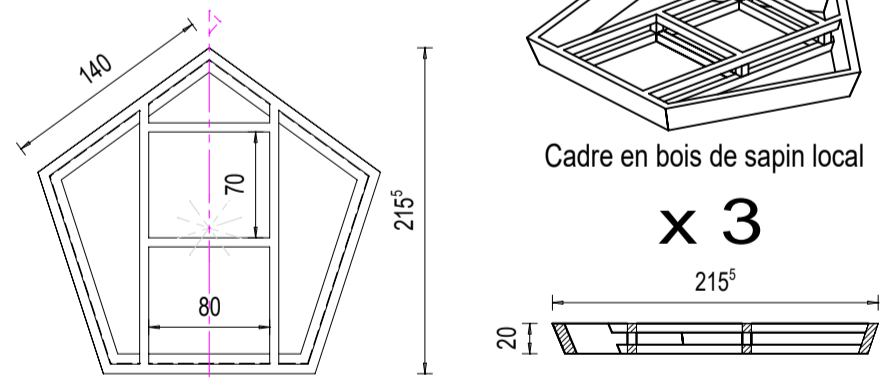
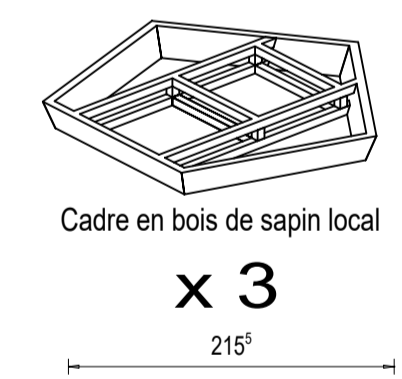
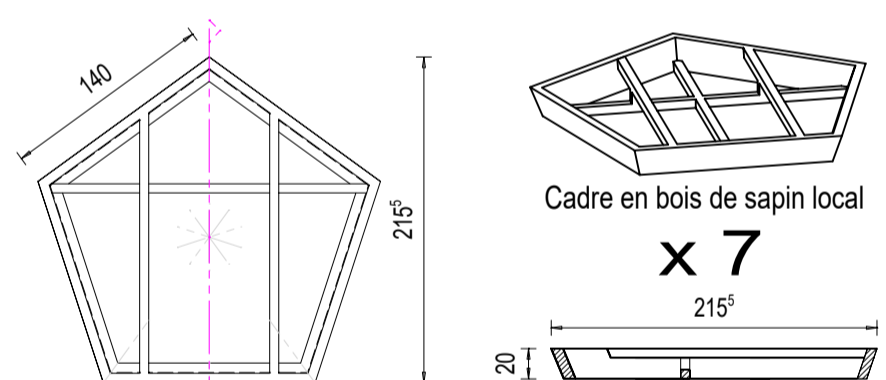
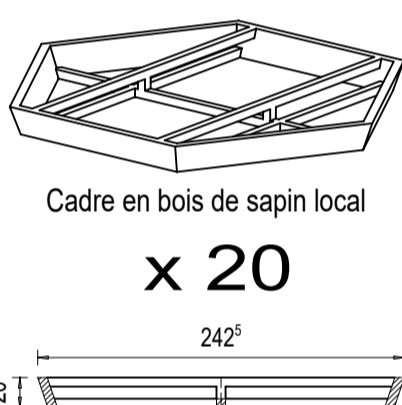
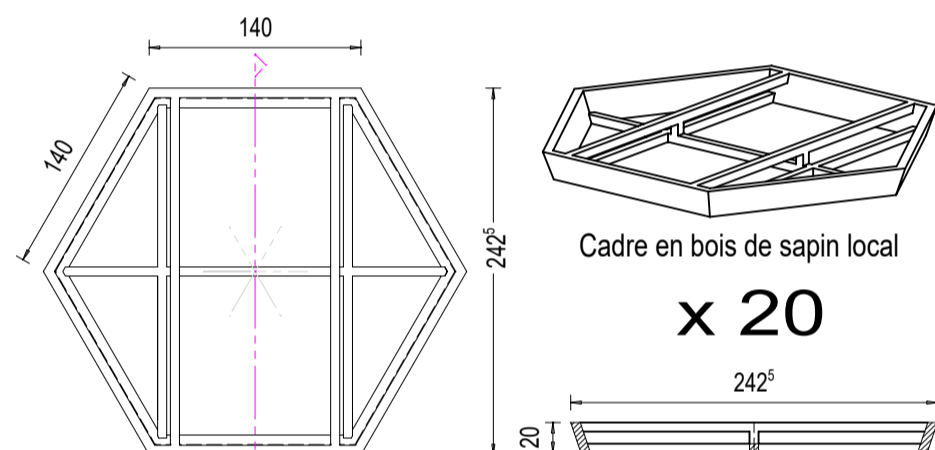

Support métallique sur le sol aplani sans fondations. Tubes d'acier rectangulaires 200 x 100 x 5 mm et 100 x 100 x 5 mm boulonnés sur place avec pièces de raccord soudées en atelier.

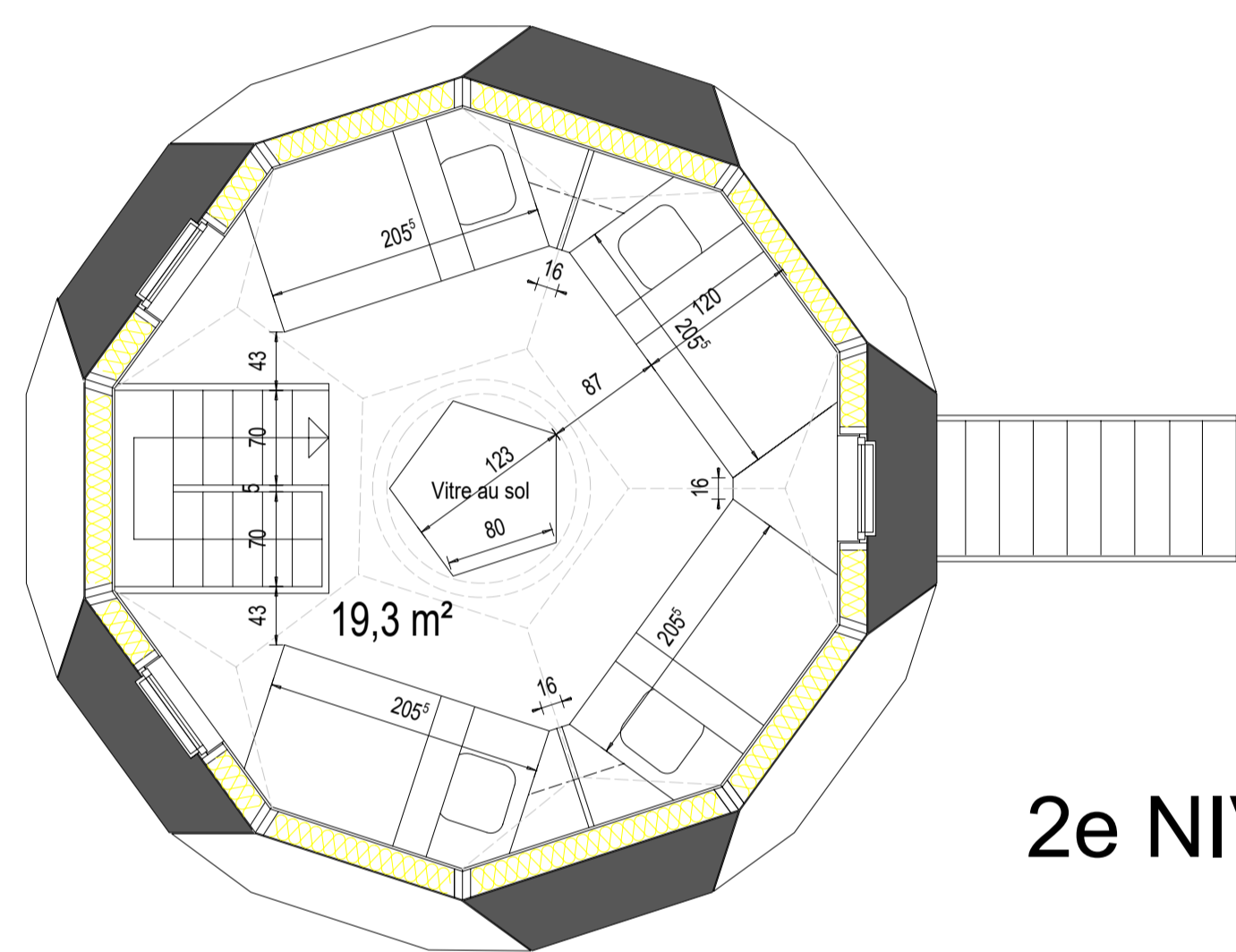

2e NIVEAU

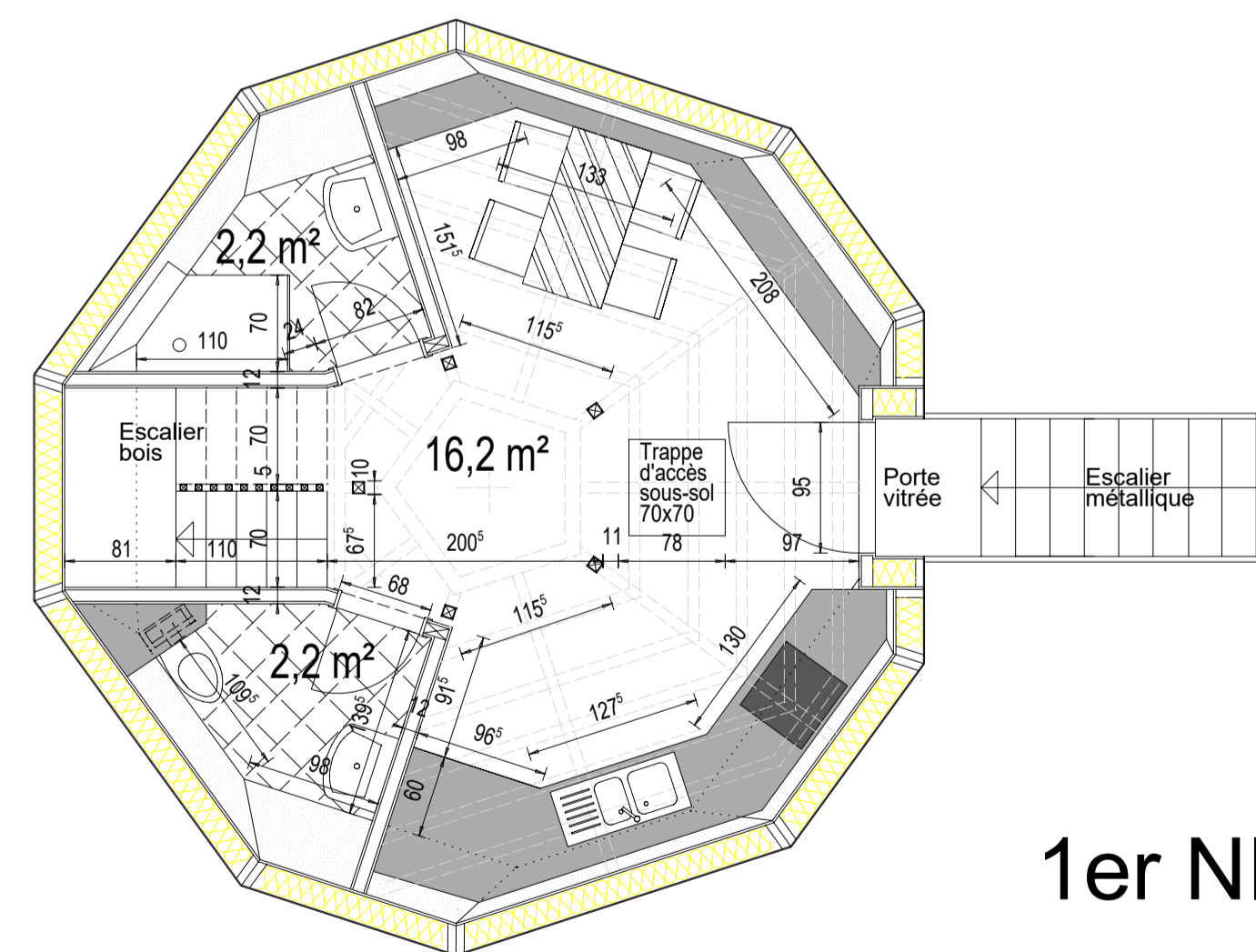
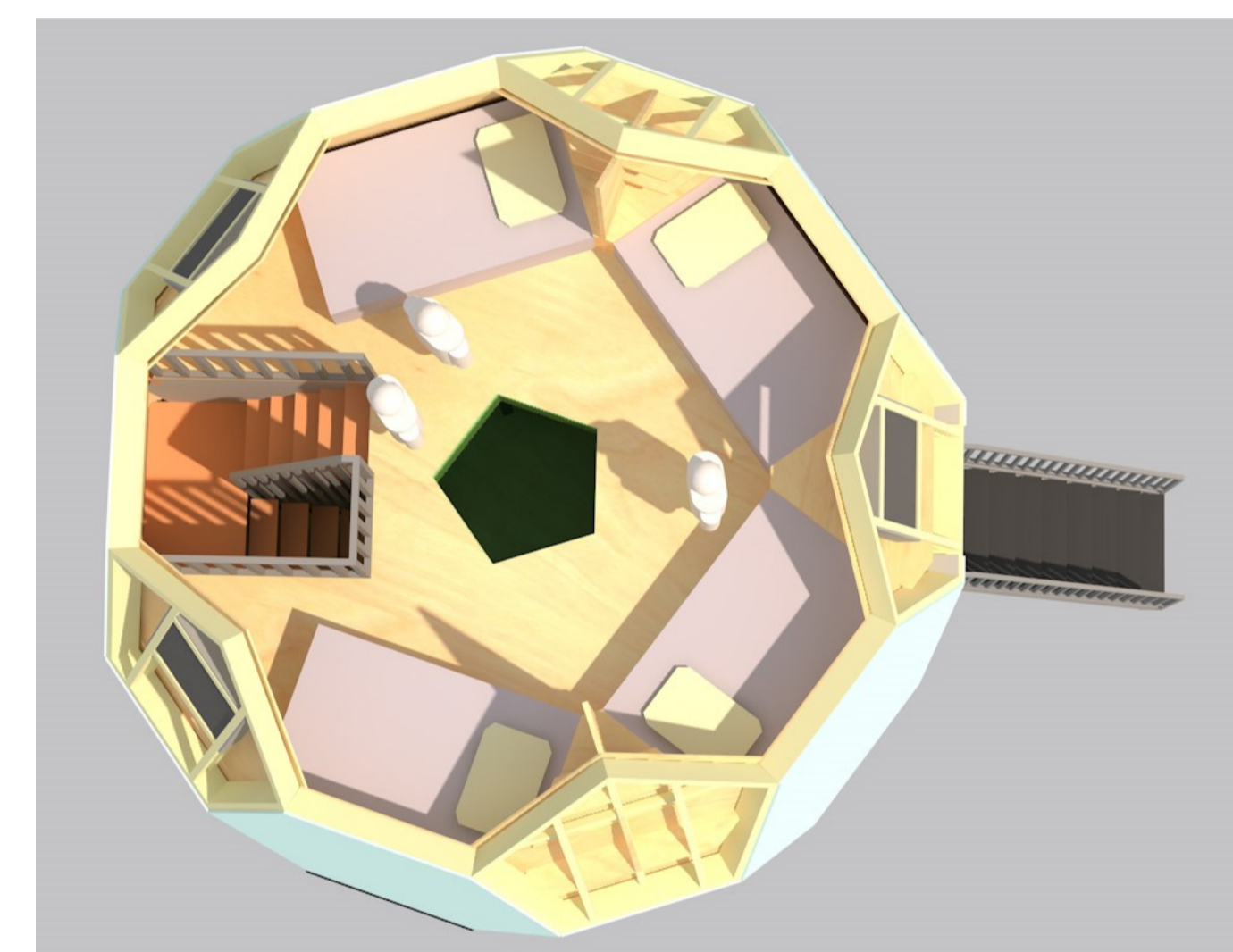

1er NIVEAU

